

Accessories suitable for

SMA 30 | 40 | 50 | 60



### Chamfer cutter heads with guide roller



66010



69769



49539



66014



66012



66015

### Chamfer cutter heads

### Guide roller

$\alpha$	to SMA	for insert	C [mm]	No.	$\emptyset$ [mm]	No.
30°	30	KX	8,0	66010	29,90	66014
	40	KX	16,0	71654		
	50	KX/DL/DX	20,0	69773		
	60	KL/DL/DX	30,0	72522		
45°	30	KX	8,0	66009	26,30	66012
	40	KX	16,0	71653		
	50	KX/DL/DX	20,0	69769		
	60	KX/DL/DX	30,0	72263		
60°	30	KX	8,0	66011	25,00	66015
	40	KX	16,0	71655		
	50	KX/DL/DX	20,0	69772		

\* other angle versions on request

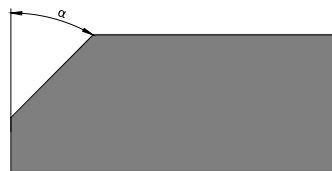

Accessories suitable for

# SMA 30 | 40 | 50 | 60



## Chamfer cutter heads with small guide roller



70631



70626

### Chamfer cutter heads

### Guide roller

$\alpha$	to SMA	for insert	C [mm]	No.	$\emptyset$ [mm]	No.
45°	30	SX	5,0	69863	12,35	70631
	40	M	7,0		10,00	70626

## Chamfer inserts



66113



62954



49534



53538



64877



63637



65932



56508

	Field of application	Details	No.
SX	Alu, Plastic	SX-B10, C = 7, Cutting edges = 8	66113
	Steel, Stainless steel	SX-B12, C = 7, Cutting edges = 8	62954
M	Alu, Plastic	M-B10, C = 11, Cutting edges = 4	53539
	Steel, Stainless steel	M-B12, C = 11, Cutting edges = 4	49354
	High-strength steel	M-B15, C = 11, Cutting edges = 4	53538
KX	Alu, Plastic	KX-B10, C = 9, Cutting edges = 8	64877
	Steel, Stainless steel	KX-B12, C = 9, Cutting edges = 8	63637
	High-strength steel	KX-B15, C = 9, Cutting edges = 8	64878
DL	Alu, Plastic	DL-B10, C = 20, Cutting edges = 4	65932
	Steel, Stainless steel	DL-B12, C = 20, Cutting edges = 4	56508
	High-strength steel	DL-B15, C = 20, Cutting edges = 4	48258
DX	Steel, Stainless steel	DX-B12, C = 20, Cutting edges = 4	74521

\* **ATTENTION:** Chamfer cutter head, guide roller and chamfer insert must fit together.

Accessories suitable for

# SMA 30 | 40 | 50 | 60



## Radius cutter head with guide roller



66009



69769



74104



69634



66018



54154

## Radius cutter heads

R [mm]	for insert	to SMA	No.
1,2 - 6,0	KX	30	66009
		40	71653
		50	69769
		60	72263
		8,0	RL
		50	
		60	
10,0 - 12,0	RD	60	54848
		60	
15,0		60	74104

## Guide roller

R [mm]	∅	No.
1,2	26,65	69634
	33,87	69635
2,0	26,65	69634
	32,30	69636
2,5	28,80	66016
3,0	28,55	66018
4,0	27,55	66019
5,0	27,05	71728
6,0	26,80	69878
8,0	42,40	54154
10,0	41,20	54849
12,0	39,50	65990
15,0	36,49	74105

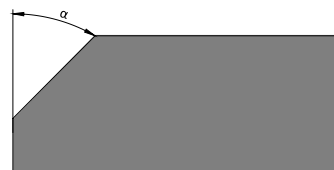
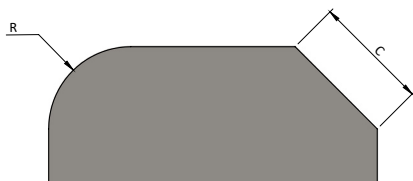

Accessories suitable for

# SMA 30 | 40 | 50 | 60



## Radius cutter heads with small guide roller



69634



66018



54154

### Radius cutter heads

R [mm]	for insert	to SMA	No.
1,2 - 3,0	SX	30 40	69863
	M		
	SX		
	M		

### Guide roller

R [mm]	Ø	No.
1,2	12,35	70631
	18,72	70630
2,0	10,94	69864
	18,40	69865
2,5	14,23	70628
3,0	10,00	70626
	17,65	70627

## Radius inserts



66108



62955



54006



54118

	Einsatzgebiet	Details	Artikel-Nr.
SX	Alu, Plastic	R = 1,2, SXR1,2-B20, Cutting edges = 16	66108
	Steel, Stainless steel	R = 1,2, SXR1,2-B22, Cutting edges = 16	66106
	Alu, Plastic	R = 2,5, SXR2,5-B20, Cutting edges = 8	66107
	Steel, Stainless steel	R = 2,5, SXR2,5-B22, Cutting edges = 8	62955
M	Alu, Plastic	R = 2,0, MR2-B10, Cutting edges = 8	54121
	Steel, Stainless steel	R = 2,0, MR2-B12, Cutting edges = 8	54006
	High-strength steel	R = 2,0, MR2-B15, Cutting edges = 8	54120
	Alu, Plastic	R = 3,0, MR3-B10, Cutting edges = 8	54119
	Steel, Stainless steel	R = 3,0, MR3-B12, Cutting edges = 8	53063
	High-strength steel	R = 3,0, MR3-B15, Cutting edges = 8	54118

\* ATTENTION: Radius cutter head, guide roller and radius insert must fit together.

Accessories suitable for

SMA 30 | 40 | 50 | 60



## Radius inserts



64993



63641



74220

	Field of application	Details	No.
KX	Alu, Plastic	R = 1,2, KXR1,2-B20, Cutting edges = 16	73258
	Steel, Stainless steel	R = 1,2, KXR1,2-B22, Cutting edges = 16	69604
	Alu, Plastic	R = 2, KXR2-B20, Cutting edges = 16	71907
	Steel, Stainless steel	R = 2,0, KXR2-B22, Cutting edges = 16	69605
	High-strength steel	R = 2,0, KXR2-B25, Cutting edges = 16	74220
	Alu, Plastic	R = 2,5, KXR2,5-B20, Cutting edges = 8	64993
	Steel, Stainless steel	R = 2,5, KXR2,5-B22, Cutting edges = 8	63639
	High-strength steel	R = 2,5, KXR2,5-B25, Cutting edges = 8	65277
	Alu, Plastic	R = 3,0, KXR3-B20, Cutting edges = 8	64995
	Steel, Stainless steel	R = 3,0, KXR3-B22, Cutting edges = 8	63640
	High-strength steel	R = 3,0, KXR3-B25, Cutting edges = 8	65278
	Alu, Plastic	R = 4,0, KXR4-B20, Cutting edges = 8	64996
	Steel, Stainless steel	R = 4,0, KXR4-B22, Cutting edges = 8	63641
	High-strength steel	R = 4,0, KXR4-B25, Cutting edges = 8	65279
	Alu, Plastic	R = 5,0, KXR5-B20, Cutting edges = 8	66170
	Steel, Stainless steel	R = 5,0, KXR5-B22, Cutting edges = 8	71659
	High-strength steel	R = 5,0, KXR5-B25, Cutting edges = 8	73273
	RL	Alu, Plastic	R = 6,0, KXR6-B20, Cutting edges = 8
Steel, Stainless steel		R = 6,0, KXR6-B22, Cutting edges = 8	69606
High-strength steel		R = 6,0, KXR6-B25, Cutting edges = 8	74219
Alu, Plastic		R = 8,0, RL8-B00, Cutting edges = 4	70495
Steel, Stainless steel		R = 8,0, RL8-B12, Cutting edges = 4	54158
High-strength steel		R = 8,0, RL8-B05, Cutting edges = 4	62698

\* ATTENTION: Radius cutter head, guide roller and radius insert must fit together.

Accessories suitable for

# SMA 30 | 40 | 50 | 60





## Radius inserts

	Field of application	Details	No.
RD	Alu, Plastic	R = 10,0, RD10-B00, Cutting edges = 2	62774
	Steel, Stainless steel	R = 10,0, RD10-B12, Cutting edges = 2	54850
	High-strength steel	R = 10,0, RD10-B15, Cutting edges = 2	63347
	Steel, Stainless steel	R = 12,0, RD12-B12, Cutting edges = 2	65991
	High-strength steel	R = 12,0, RD12-B15, Cutting edges = 2	65992
	Alu, Plastic	R = 15,0, RD15-B00, Cutting edges = 2	63709
	Steel, Stainless steel	R = 15,0, RD15-B12, Cutting edges = 2	51896

\* **ATTENTION: Radius cutter head, guide roller and radius insert must fit together.**

## Accessories

	Description	Details	No.
 	<b>Jokisch Solis Pina V4B wax pencil</b>	for edge milling of SS/ MS, 300 g	70516
	<b>Screw grease</b>	tube with 14g	32202

70516

32202

## Spare parts

	Description	Details	No.
	<b>Couple of carbon brushes</b>	SMA 30	59256
	<b>Couple of carbon brushes</b>	SMA 40	74226
	<b>Couple of carbon brushes</b>	SMA 50 / 60	73320
	<b>Screw</b>	for insert M, T, KX, DL and DX	51302
	<b>Screw</b>	for insert SX	68411