

AF 165

Deburring machine with Sanding Disk

Its specialty includes the removal of saw burrs and heavy roughing burrs so that workpieces can be further processed and are safe to use. Fast, cost-effective edge grinding is achieved with long-life flap wheels, CBN or diamond grinding wheels.



AF 165

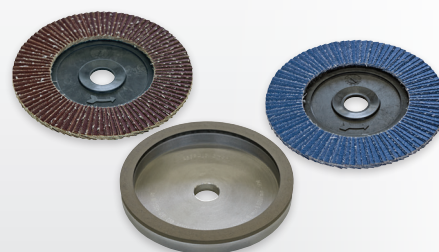

Further accessories can be found in our **Accessory Catalogue**.



Applications

- ▶ Minimum workpiece thickness 3 mm
- ▶ Applicable for steel, aluminium, brass, copper, synthetic material, from soft synthetic material to acrylic glass, wood and much more
- ▶ For hardened steel CBN-wheels
- ▶ For carbide metal diamond wheels

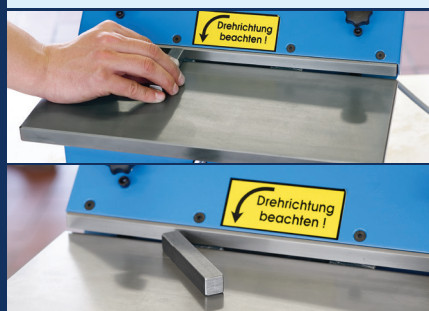

Features

- ✔ Easy operation
- ✔ Uncomplicated tool change
- ✔ Stepless chamfer adjustment
- ✔ Hardened guide rails
- ✔ Clean working place due to extraction device

Options

- ✔ Table extension
- ✔ Dust extraction
- ✔ Flap disks for steel or stainless steel with different grain sizes
- ✔ CBN- and diamond grinding wheels

Delivery contents

- ✔ Flap discs with special bond
- ✔ Extraction socket
- ✔ Operating manual

Technical data

AF 165

Motor	0.37 kW 2,800 rpm
Table size	180 x 370 mm
Energy	400 V, 50/60 Hz
Maximum chamfer width	1 mm
Flap disc	ø 165 mm
Dimensions (L×W×H)	370 x 520 x 320 mm
Weight	25 kg
Item no.	19281